

FUSION™ MBBB SERIES

Solid Door Back Bar Refrigerators

MODELS

- ☐ MBBB59
- ☐ MBBB69
- ☐ MBBB79
- ☐ MBBB95



MBBB79



Approved to NSF standard for packaged food products.

FEATURES

CONSTRUCTION

- Stainless steel top
- Black exterior finish on front, sides and back
- Galvanized steel interior with stainless steel floor
- Foamed-in-place with low ODP polyurethane insulation
- Wall thickness: 1-1/2"
- Two adjustable shelves per section
- Interior LED lighting
- Adjustable temperature control
- Internal height capacity allows stacking of three longneck beers

DOORS

- Standard door locks on each door
- Magnetic door gaskets, removable without tools
- Door openings have plastic breaker strips to reduce condensation

REFRIGERATION

- Self-contained refrigeration system metered by capillary tube
- Front breathing compressor on left side
- Evaporator coils coated to resist corrosion
- Condensate evaporator
- Slide-out condensing unit for easy cleaning and service
- Refrigerant: R290
- Temperature range: 34° to 38°F (1° to 3°C)

WARRANTY

- Standard limited three year parts and labor
- Additional two year coverage on compressor part

OPTIONS

- ☐ Shelves with bottle dividers
- ☐ 4" plate casters
- ☐ Floor protector kits
- ☐ Glass doors

TECHNICAL SPECIFICATIONS

Models	MBBB59	MBBB69	MBBB79	MBBB95
Crated Weight (lbs) (kg)	238 (108)	271 (123)	311 (141)	348 (158)
Crated Height (in) (mm)	44 (1118)	44 (1118)	44 (1118)	44 (1118)
Crated Width (in) (mm)	61 (1549)	71 (1803)	83 (2108)	98 (2489)
Crated Depth (in) (mm)	30 (762)	30 (762)	30 (762)	30 (762)
Interior Height (in) (mm)	32 (813)	32 (813)	32 (813)	32 (813)
Interior Width (in) (mm)	54-3/4 (1391)	64-3/4 (1645)	76-1/2 (1943)	91 (2311)
Interior Depth (in) (mm)	21-1/2 (546)	21-1/2 (546)	21-1/2 (546)	21-1/2 (546)
Overall Height (in) (mm)	37 (940)	37 (940)	37 (940)	37 (940)
Overall Width (in) (mm)	59 (1499)	69-1/8 (1756)	80-3/4 (2051)	95-1/4 (2419)
Overall Depth (in) (mm)*	29-5/8 (752)	29-5/8 (752)	29-5/8 (752)	29-5/8 (752)
Gross Cubage (CuFt) (L)	19.4 (549)	23.4 (663)	27.9 (790)	33.6 (951)
Number of Shelves	4	4	6	6
Shelf Area (SqFt) (Sqm)	14.1 (1.31)	16.9 (1.57)	19.8 (1.84)	22.6 (2.1)
Condensing Unit Size	3/8 HP	3/8 HP	3/8 HP	3/8 HP
Refrigerant	R290	R290	R290	R290
Electrical Characteristics	115/60/1	115/60/1	115/60/1	115/60/1
Cord and Plug Furnished	Yes	Yes	Yes	Yes
NEMA Plug Configuration	5-15P	5-15P	5-15P	5-15P
Total Amp Draw	3.5	3.5	3.5	3.5
12 oz. Can Capacity	1084	1299	1566	1875
12 oz. Bottle Capacity	498	594	714	858

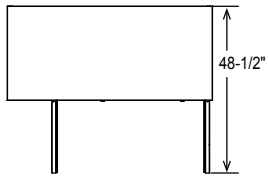

MBBB59 PLAN VIEW

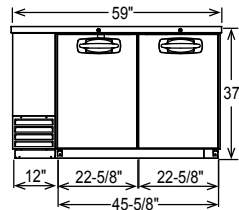

MBBB59 ELEVATION VIEW

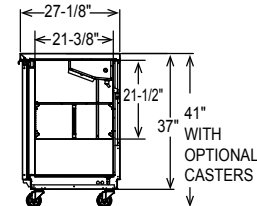

**ALL MODELS
SIDE VIEW**

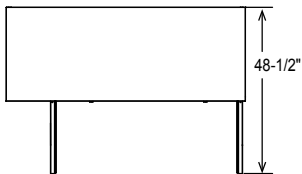

MBBB69 PLAN VIEW

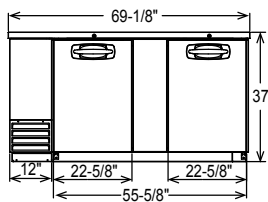

MBBB69 ELEVATION VIEW

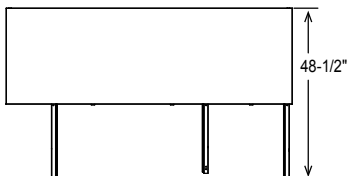

MBBB79 PLAN VIEW

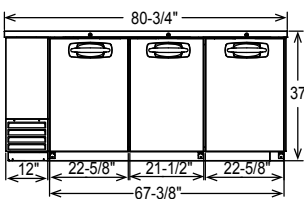

MBBB79 ELEVATION VIEW

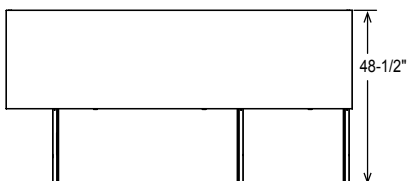

MBBB95 PLAN VIEW

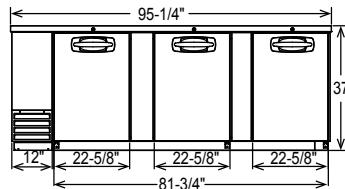

MBBB95 ELEVATION VIEW

LISTINGS

Intertek

Approved to NSF standard for packaged food products.

HOOKUP

All models via plug in, 9 foot long flexible three wire 14 gauge cord with molded plug.



NEMA 5-15P

BID SPECIFICATIONS

Item no. MBBB _____.

Provide _____ Solid Door Back Bar Refrigerator, Master-Bilt® model no. MBBB _____.

Back bar refrigerator will feature stainless steel top with black finish on front, door, sides and back. Interior will be galvanized steel with stainless steel floors. Door openings will have plastic breaker strips to reduce

condensation. Adjustable shelves and interior LED lighting will also be standard.

The refrigeration system will be self-contained and use R290 refrigerant. The temperature range will be 34° to 38°F (1° to 3°C).

System will be equipped with coated evaporator coils and a condensate evaporator. Condensing

unit will be slide-out type for easy cleaning and service.

Refrigerator to have standard limited three year parts and labor warranty with additional two year coverage on compressor part.

Refrigerator to be UL, C-UL and ETL Sanitation listed as well as approved to NSF standard for packaged food products.

NOTE: Cabinet designed for optimum performance in air-conditioned area at 75°F ambient and 55% relative humidity.
All specifications within this publication subject to change without notice.