

WALK-IN FLOORING GUIDE

Your walk-in cooler or freezer is a key investment, essential for safe and sanitary product storage. To protect that investment and ensure long-lasting performance, choosing the right flooring is critical.

By evaluating factors like product weight, transport methods, and traffic levels, you can select the best solution. Whatever your needs, Norlake offers durable flooring designed to support your operation.

FLOOR TYPES TO FIT ALL NEEDS

STANDARD

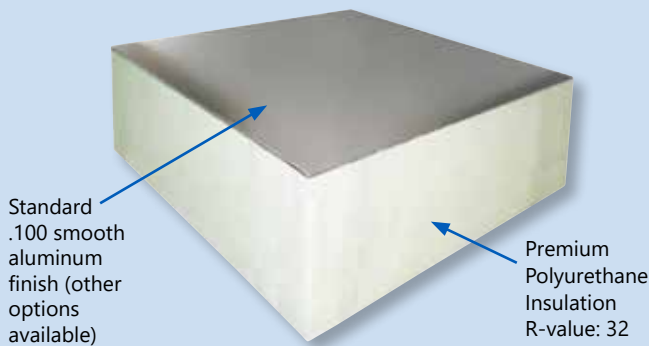

Foot traffic, lighter product storage

HEAVY-DUTY



Heavy foot traffic and light rolling carts

STRUCTURAL

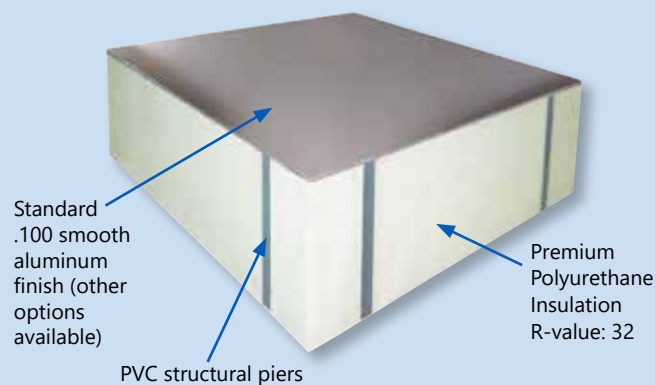

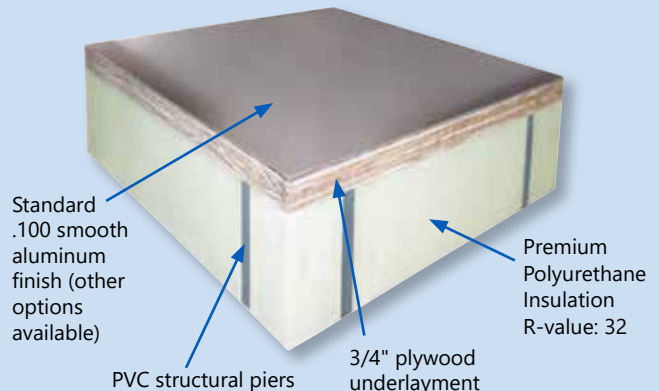

Heavy stationary loads, hand-operated pallet jacks, no electric pallet jacks or forklifts

HEAVY-DUTY STRUCTURAL



Heavy stationary loads, medium-duty pallet jacks, no electric pallet jacks or forklifts

EXPLORE THE OPTIONS

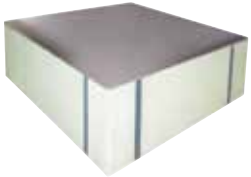
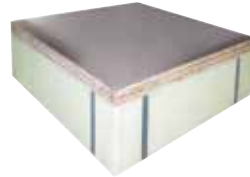
	 STANDARD	 HEAVY-DUTY	 STRUCTURAL	 HEAVY-DUTY STRUCTURAL
Application	Foot traffic, lighter product storage	Heavy, high-volume foot traffic, light rolling cart traffic	Heavy stationary loads, hand-operated pallet jacks, excluding electric pallet jacks or forklifts	Heavy stationary loads, medium-duty pallet jacks, excluding electric pallet jacks or forklifts
Rated Load (Evenly Distributed)	800 psf	1000 psf	5000 psf evenly distributed, 1000 psf mobile	15,000 psf evenly distributed, 5000 psf mobile
Available Finishes	<ul style="list-style-type: none"> .100 smooth aluminum (standard) .080 diamond tread plate aluminum 16 gauge stainless steel 16 gauge galvanized steel 	<ul style="list-style-type: none"> .100 smooth aluminum (standard) .080 diamond tread plate aluminum 16 gauge stainless steel 16 gauge galvanized steel 	<ul style="list-style-type: none"> .100 smooth aluminum (standard) .080 diamond tread plate aluminum 16 gauge stainless steel 16 gauge galvanized steel 	<ul style="list-style-type: none"> .100 smooth aluminum (standard)
Underlayment	N/A	3/4" plywood	PVC structural piers	3/4" plywood on top of PVC structural piers
Overlay	N/A	Optional, standard overlay finishes	N/A	3/16" diamond aluminum, field installed overlapping floor panel joints

WHAT ABOUT FORKLIFT TRAFFIC?

Electric pallet jacks and forklifts require an insulated concrete slab with breaker strips (thermal breaks) that come up to the finished floor surface for the wall panels to sit on.

Breaker strips are pieces of 2-inch polyurethane foam that prevent heat transfer between the concrete floor's cold and warm (ambient) sides.

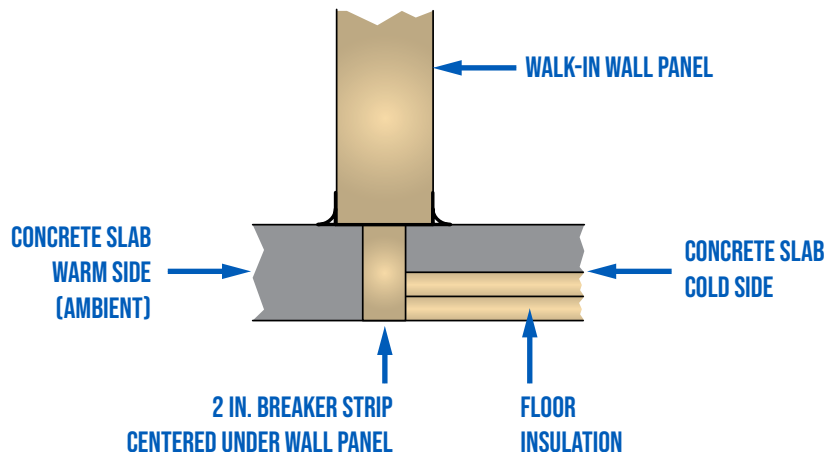

RSG Refrigerated Solutions Group®
891 County Road U
Hudson, WI 54016
800-955-5253

norlake.com • norlakescience.com • master-bilt.com

